

For R/W Data - See Rdwy. Plans

DATE REVISED	DATE FILMED	DATE REVISED	DATE FILMED	FED. ROAD DIST. NO.	STATE	FED. AID PROJ. NO.	SHEET NO.	TOTAL SHEETS
				6	ARK.			
				JOB NO.		110395	18	203
				06830		LAYOUT		47016

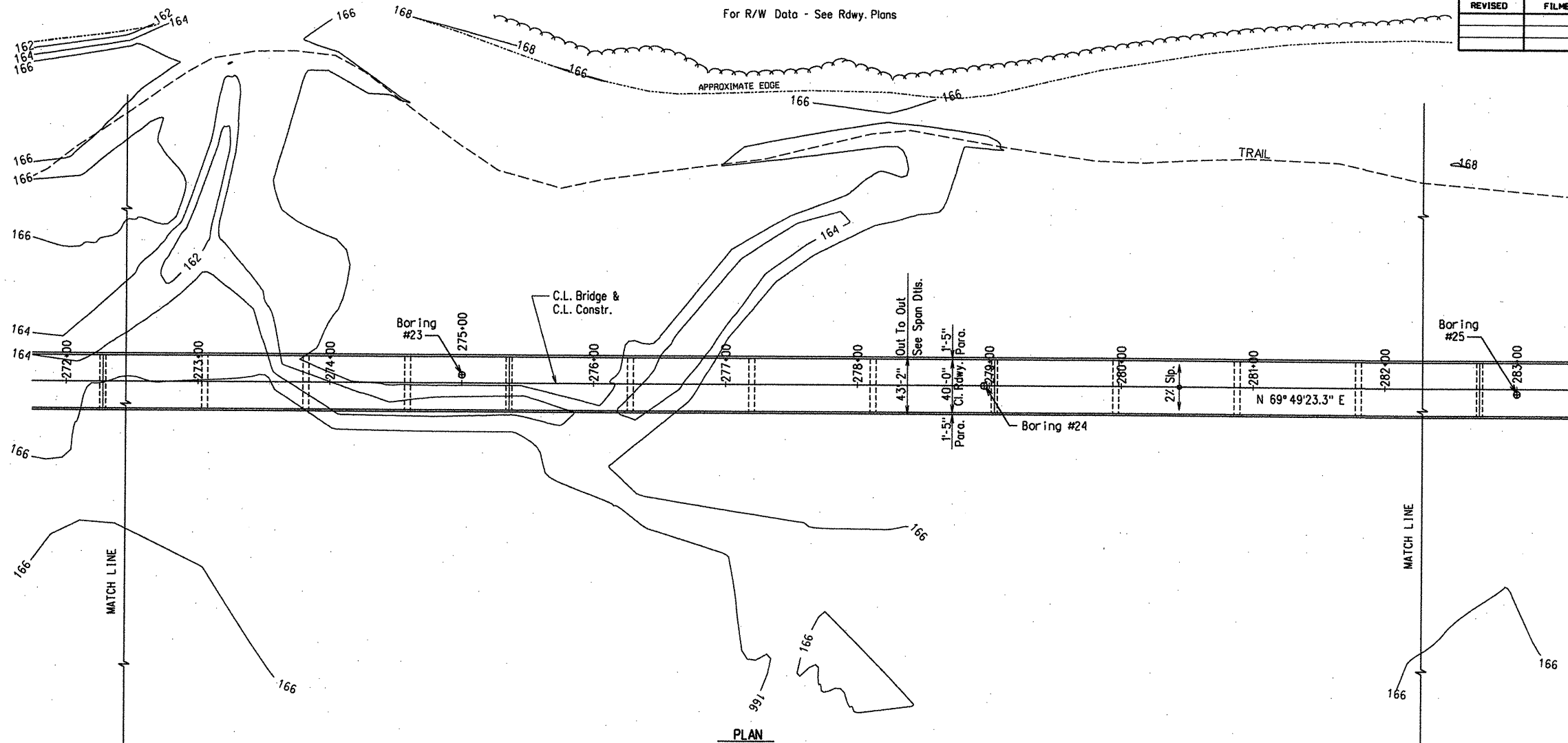

PLAN

Total Length of Bridge (Ph. II & III) = 9468'-3 1/8"

Total Length of White River Bridge in Phase III = 6955'-1 1/4"

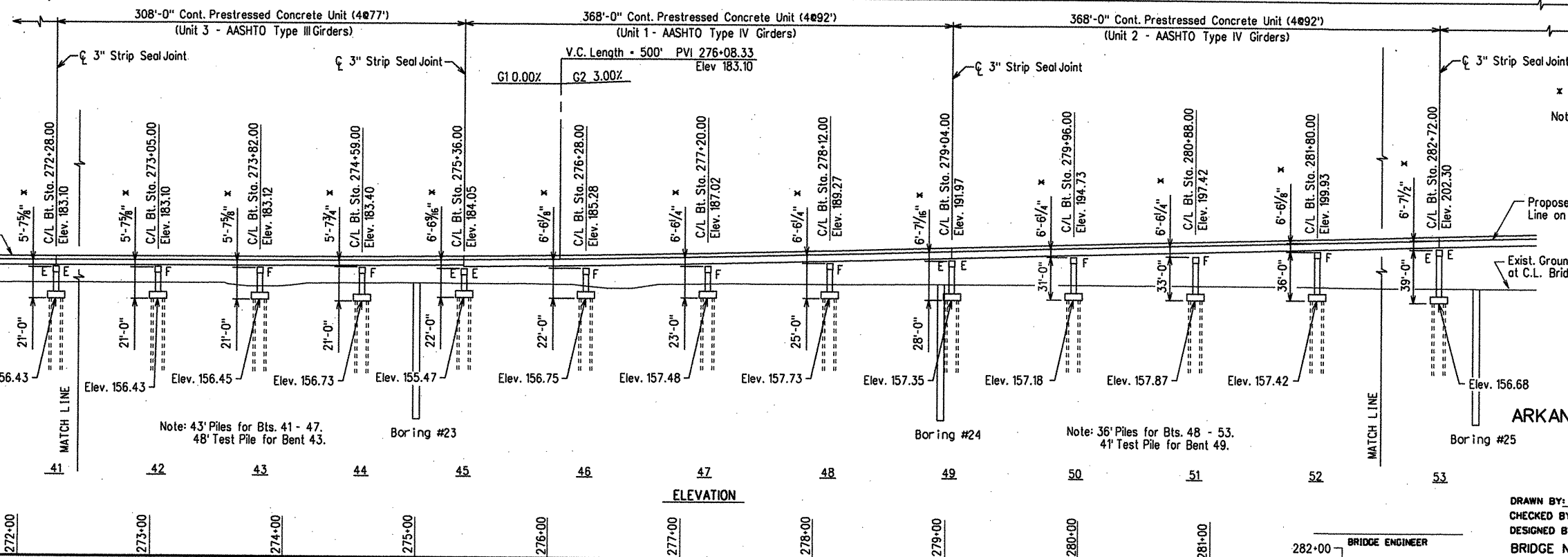

Strip Seal Joints are designated as "X" Strip Seal Joints where "X" represents the "A" dimension at 60 degrees F as shown in the table on dwg. no. 47095 - 47099.

* Top of Deck at C.L. Bridge and C.L. Bent to Low End of Cap
Note: See dwgs. no. 47024 - 47028 for Soil Borings & additional data.
See dwg. no. 47023 for General Notes.
See dwg. no. 47020 for Hydraulic Data Table.

ALTERNATE NO. 1

LAYOUT OF BRIDGE OVER WHITE RIVER
(SHEET 5 OF 9)
WHITE RIVER STR. & APPRS.
(CLARENDON) (PH. III) (F)
MONROE COUNTY
ROUTE 79 SEC. 13
ARKANSAS STATE HIGHWAY COMMISSION
LITTLE ROCK, ARK.

Engstrom / Modjeski and Masters

DRAWN BY: LKD/TAD DATE: Sep. 10 FILENAME: b1103951.i05.dgn
CHECKED BY: FS DATE: Sep. 10 SCALE: 1" = 50'-0"
DESIGNED BY: YO DATE: Sep. 10
BRIDGE NO. 06830 DRAWING NO. 47016